

The Tequila



Product Details

- Continuous Blower Inflatable
- Internal or External Blower Placement
- Waterproof, Fire-Retardant Fabrics
- 100% Fully Printable Surface
- Included Heavy-Duty Transport Bag
- Ground and Roofline Anchoring Points
- Custom Models and Modifications on Request

Wind Safety & Securing

- Secure your inflatable with anchor straps via reinforced d-ring anchor points around the base and roof.
- Product is most secure on stable, solid surfaces with anchoring stakes firmly set into the ground.
- For soft ground conditions (sand, gravel) base weights can be placed inside the inflatable.
- Recommended use at wind speeds up to 25mph.



Product Dimensions

Entrance Height	6' 2" (187cm)
Total height	26' 3" (800cm)
Covered Area	29' 1" x 29' 1" (886 x 886cm)
Pack Size (L x W x H)	39 x 55 x 35.4" (100 x 140 x 90cm)
Weight	242lbs (110kg)
Assembly Time	Within 5 Minutes
Production Time	Approx. 3-6 Weeks from Order
Printing	Full Surface Dye-Sublimation Printing
Textile Properties	Oxford 500D
Waterproof Rating (DIN EN 20811)	✓ 2x Industry Avg 2,000mm Water Column
Fire Rating Class B-s2, d0 (difficult to ignite)	NFPA 701, CPAI-84 Sec.6, EN 13501-1:2019, CAN/ULC-S109, CA Title 19 Sec. 1237
Fade Resistance (DIN EN ISO 105-B02)	Durable, UPF 50+ (blue scale 4.5-6.5 of 8.0)

Total Height
26' 3" (800cm)

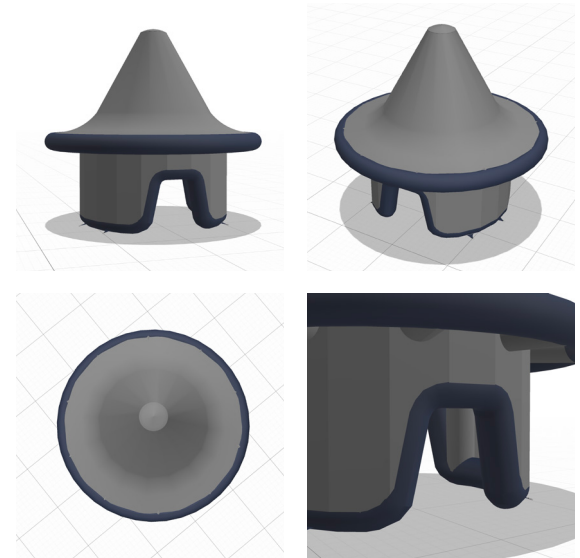

Mastertent inflatables are flexible due to the nature of their construction. Set-up placement and the positioning of the inflatable structure can result in variation from the provided dimensions. For example, placing the bases of the inflatable farther apart will reduce the overall height. **Rely on your Product Expert for any additional questions or product information.**